

[illegible]

39

LIVESTOCK

SW-6	16/2/04	TKANWA- to 17-10-03
895885 36190N		1161 CAN 102

PEITIC	JUST	ACTON QTRIDE.

S: 302/785

SW-7. 89160E-36571N

10m

← P

folded BY E-veering

Q₄₂-S₄₁₁F.

F_{0.10} (S-Peena)

$S_u = 21178W$
 S_u (quadr)
 $S_c = 010195W$
 $A = 31180$
 $A = 701195$

SW-9 Q12-SCH-115 O →
SOM VES OF SW-8 W
23185NE
348880
SUC
A: 751352
5/1

①

SW-21

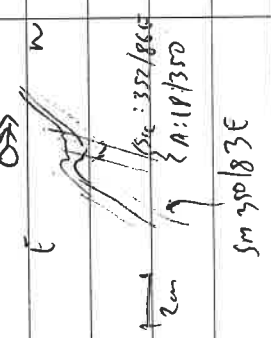

93256E
30599N

Longgong River Along

GIBLIN RIVER

Sm 30183E

18/2/04

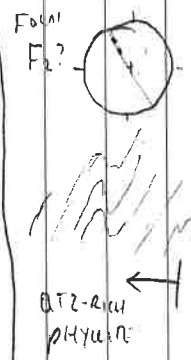

GRAPHIC PHYLLITE

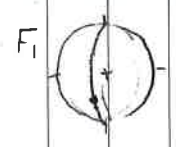

GRAPHIC PHYLLITE

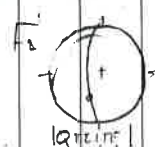

MYLONITE

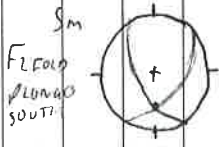

GARNET-BEARING SCHIST

SCHEMATIC SECTION OF HEADLAND

AT NORTH END OF NYE BAY

(FROM HONOURS THESIS OF ANDREW McNEILL 1985)

- Amphibolite
- Cambrian Granitoid

SW-22 TOP OF NYE BAY 92472E 32660N

18/2/04 1st outcrop within Longgong River

MARKED DOUBLY PLUNGING DUAL (SEE SECTION)

Strong Mineral Lamination with mica growth

Fold interference

Pattern B/W

W 6 NW SET 50cm

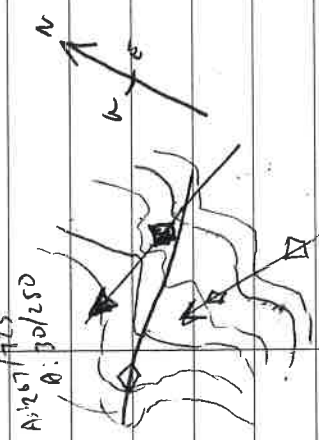

Spiral Lamination

Sm: 155/28N Lm: 8/141

Sm: 167/46W Lm: 12/172

A: 307/99N

A: 32/298

SW-22 32-298 Fold hinge

Synclinal Line Marks

Axial Plane

18/2/04

SW-23 QZ-MICA SCHIST WITH
INTENSE CRYSTALLIZATION (CONTINUED)
Σ₁ TOP OF FOLD MARKED WITH
ARROW → 48/174

SW-24A ALBITE-SCHIST → TOP OF S₁ FOLG.
92183E GT BEAKING. 195/24W
22520W

SW-24B GT-BEAKING SCHIST 204/86N FACE ONLY

SW-24C GT-BEAKING SCHIST NORTH ARROW MARK
ALSO → 108/90 → 2

SW-25A Qtz-Schist → FACED
25_B NOT DIRMAT 218/40W

SW-26 → ARROW ON TOP OF GRANITE
TO 155 S₁ mark.

GRANITE FOLDED
S₁ 340/80W
DYKE IN SECTION

SW-27 START OF "MYLONITE" ZONE
ACTUALLY CATACLASTIC WITH STRONG
DOWN-DIP ELONGATION LINATION.
TWO SAMPLES

SW-27A → 162/75W
SW-27B → 176/83W
S₁ MARK ON UNDERSIDE OF SAMPLE.

REGION OF HIGH STRAIN ZONE
S₁ 344/79W L-83S
S₁ 342/72W L-85S
S₁ 342/70 L-188S

SW-28 S₁ ON WEST SIDE OF BURN
352/64W →

SW-29A 184/54W
29A UNOBLIN 10716

SW-30 Σ₁ → 342/68W
LOW STRAIN ZONE

SW-31 Σ₁ DISRUPTED S₁ IN FOOT WALL
OF HIGH STRAIN ZONE 342/60W →
OVER TURN.

7/74W

\$

OR SW-34

76

170W \angle 14°N

64

265

20/2/04

TRAVEL S OF MULLAGH - 1



SKETCH OF LITHOLOGY

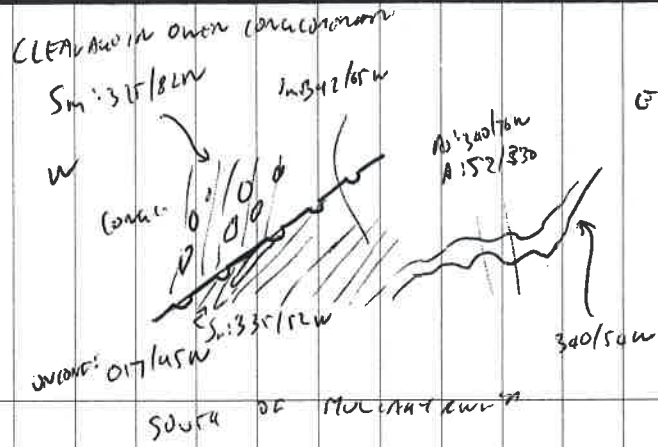
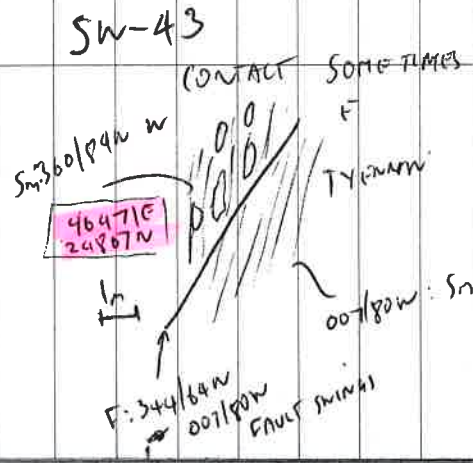

TRAVEL THROUGH

SW-44

20/2/04

QUARTITE

HUTT PLAINS

NOR

SAMPLE SW-44

CRATERED NO. 15

LOCALITY

CRATER

S.M. 360/194W

QUARTITE

98290E

22655N

SW-45 1st EXPOSURE ON BOOTH

98004E

21478N

DETECT (SHEAR BANDS IN

S.M. 013/85W

S.M. 356/66W

6/174: L

ROCKS ARE DOCLINAL

SW-46

S.M. 177/78W

A: 24/200

Z

350/70W NOTE

MAY BE WAGON.